



INTO THE BLUE

Painted Shaker units and Moroccan-style floor tiles have been carefully teamed to create an eye-catching kitchen/dining room.

Sally Campbell, 52, and her husband Gary, 53, live in a four-bedroom, semi-detached house in Hampton, Middlesex, with their children Tom, 18, and Erin, 16.

Over 13 years they have updated different areas, finally turning their attention to the kitchen.

CONTINUED OVER NEXT PAGE



CABINETS
Classic Shaker-style units have been painted in two shades to make the kitchen look less formal

BARSTOOLS
Turquoise brings out the colour in the tiles, pulling the whole look together

BEFORE



ACTION PLAN

REMOVE INTERNAL WALL TO THE WC

REBUILD EXTENSION, ADD
SLIDING DOORS AND ROOFLIGHTS

FIT NEW FLOORING

INSTALL KITCHEN

SHELVING
Leaving one wall free of cabinets creates a more open feel and provides an area for display

SPLASHBACK
Clear glass against the white painted walls keeps the space light and open

ISLAND
The worktop overhangs to create a neat breakfast bar

FLOORING
Moroccan-style tiles define the kitchen area within the open-plan space





STORAGE
Pullout cupboards either side of the fridge are used to store dried goods and canned food



ACCESSORIES
A selection in deep blue and turquoise complements the Moroccan-style tiles

HOUSE BEAUTIFUL SAYS...

‘There’s plenty of light and space in this modern kitchen, while the vibrant blue stools, patterned floor and warm colours give it lots of character.’



EXTENSION
Rebuilt and enlarged, it offers a closer connection to the garden

What was the kitchen like before your update?

It functioned well but was looking a little worn – and it was quite a dark and oppressive room to spend time in.

Tell us about your plans

We wanted to take out the WC in one corner of the space, so we could knock down the dividing wall and give greater width to the kitchen. We also decided to knock down the extension and rebuild a bigger version that extended a little further into the garden. Then the kitchen and dining areas were swapped around so that the dining table would be close to the folding, sliding doors and be able to take advantage of views of the garden.

You went for two types of flooring...

Yes, it was a good way to define the kitchen area within the open-plan space. We decided to use a patterned design in this zone and chose tiles with a Moroccan-influenced motif – they look fantastic and are very practical. The turquoise colourway works really well with the warm grey/brown and neutral units and makes a striking contrast with the wooden planks in the dining area.

Did you get help from a kitchen designer?

Architect Lyn Niblock-Aziz helped with the extension work. We drew up plans together, incorporating everything on our wish list, including the island with breakfast bar, the oven tower and room for a large fridge-freezer. Then I gave the plans to a designer at the showroom where we’d decided to buy everything.

How did you decide on the colour of the cabinets?

The units on display in the showroom were painted in a shade that we felt was too cold. We chose a couple of warmer, neutral hues, which provide a link with the floor tiles, and used them on different cabinets to give a relaxed, individual look.

And the lights?

They’re divided into four groups controlled by a Lutron Grafik Eye dimmable system to give different levels of light for different activities.

How do you feel about the space now?

We spend a lot of time enjoying the room and the fact that it’s so well connected to the garden area. When it comes to the fittings, I’m particularly pleased with the induction hob, which looks good and is really easy to control and clean. CONTINUED OVER NEXT PAGE

IN
DETAIL



GARDEN VIEW
Large sliding doors create a wall of glass, allowing in lots of light and providing views of the garden



SINK
Neatly set into the work surface – grooves are cut into the worktop for draining



WORKTOP
The quartz finish is hardwearing and smart

GET THE LOOK



French door **fridge-freezer**, £1,518, Caple



Richie Cobalt Blue stoneware storage jar, £12, Habitat



Mechanical **kitchen scales**, £16.99, Kitchen Craft

WHAT IT COST

Units	£10,740
Worktop	£3,700
Appliances	£4,941
Sink and taps	£633
Floor tiles	£1,124
Wooden flooring	£1,100
Total	£22,238

THE NEW LAYOUT

There's lots of space to dine in comfort in the improved extension

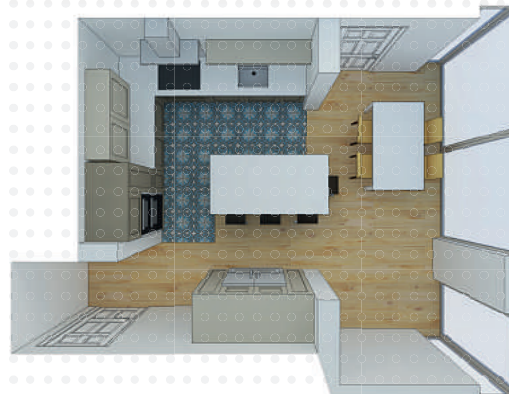

SHOPPING LIST

Walls painted in Brilliant White matt emulsion, £9.99 for 2.5L, Wickes. **Units painted** in Rolling Fog and Attic II Intelligent eggshell, £54.50 for 2.5L, Little Greene. **Units** bespoke. Similar **floor tiles**, Toulouse Ramier, £8.99 a tile, Fired Earth. **Wooden flooring**, £46 a sq metre, Reed Construction. Shaker-style 600mm **unit**, £408; Neff Slide & Hide single **oven**, £690; Neff compact **oven with microwave**, £820; Neff **warming drawer**, £351; Siemens Flex induction **hob**, £799; Elica 800mm chimney **hood**, £557; Fisher & Paykel designer multi-door **fridge-freezer**, £1,724; Franke Kubus stainless-steel under-mounted **sink**, £316; Perrin & Rowe Oberon mono mixer **C spout**, £317; all Callaghan Interiors. Compac Quartz **worktop**, £500 a sq metre, Luna Stone. Glass **splashback**, £60, Bespoke Glass Splashbacks. Premier Housewares Cubic **bar stools**, £51 each, Amazon. Pendant **light**, made to order, Jonathan Coles. Extendable **table**, £190, Ikea. Similar **dining chairs**, Oregon pine chairs by Arne Jacobsen, £430 each, The Conran Shop. Stack **Duo vase**, £70; Stack **Trio vase**, £50; blue Utility **bread bin**, £85; **container** with ash lid, £35; **utensil pot** with leather handle, £32; Coro **tumblers**, £20 for four; Basis turquoise **jug**, £27; all LSA International. Dualit **kettle**, £69.95; **toaster**, £59; Classic mechanical **kitchen scale**, £20; Mason Cash **mixing bowl**, £24; Varsity **quiche dish**, £15; all John Lewis

WORDS DILLY ORME. PHOTOGRAPHY DAVID PARMITER. PLAN CHRISTOS FINIATIDES

FOR STORE DETAILS SEE **WHERE TO BUY PAGE**